



TELEPHONE MAN OF AMERICA
1-866-770-4930
TELEPHONEMAN@TELEPHONEMANOFAMERICA.COM
Earning Your Business Every Step of the Way!
Specializing in Telecom Equipment of all Brands, Carrier Services,
Technician Services, Maintenance Agreements & Purchasing Excess
Telecom Equipment!

I will always do my best to match or beat any competitors bid!

TELEPHONE MAN OF AMERICA

Earning Your Business Every Step of the Way!

Specializing in Telecom Equipment of all Brands, Carrier Services, Technician Services, Maintenance Agreements & Purchasing Excess Telecom Equipment!

I will always do my best to match or beat any competitors bid!

| Local: 863-614-1900| Toll Free: 866-770-4930| Fax: 888-782-3072|

Email: telephoneman@telephonemanofamerica.com |

URL: www.TelephonemanOfAmerica.com| URL: www.shop.telephonemanofamerica.com |

TalkSwitch VoIP

Drill Template

For wall-mounting TalkSwitch

To hang TalkSwitch on a wall, drill these two holes.

Mounting multiple units? It is recommended that you arrange them in a horizontal row to provide better ventilation.



Required Materials



Drill Bit: Size is determined by the anchors or screws. See the directions that came with your fasteners.



x2

Anchors: Needed for mounting on drywall, plasterboard or gyprock.



x2

Screws: Wood screws or screws appropriate for anchors.

4 Insert anchor (drywall, plasterboard or gyprock).



5 Insert screws. Leave the screws sticking out by about $\frac{1}{8}$ ".

6 Place TalkSwitch key holes over the protruding screws and slide down into position (TalkSwitch can be placed in either position shown).

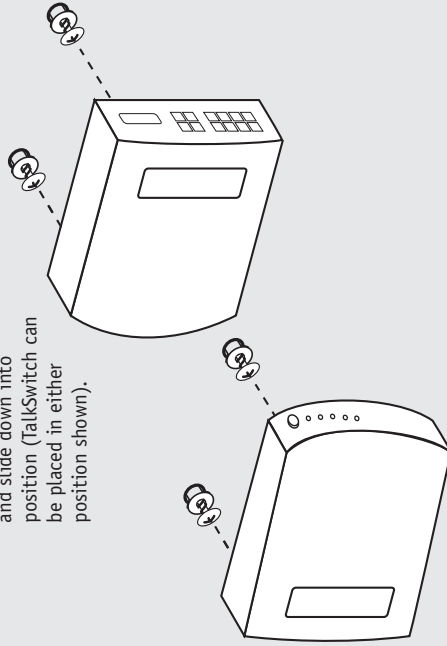

1 Tape template to wall in the desired orientation.

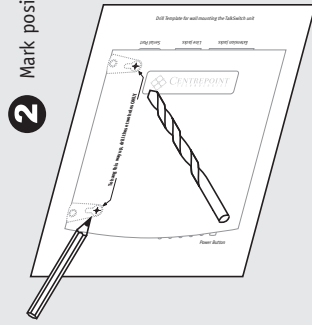

2 Mark position of drill holes on wall.

3 Drill pilot holes.

